









-  : Bus Stop Location
-  : Location of Existing Trees
-  : Potential Removal of Trees
-  : Installation of Custom Inlet
-  : Installation of Traffic Signal





-  : Property/ROW line
-  : Location of existing pavement
-  : Road pavement
-  : Bike Lane
-  : Sidewalk
-  : Landscaping Area

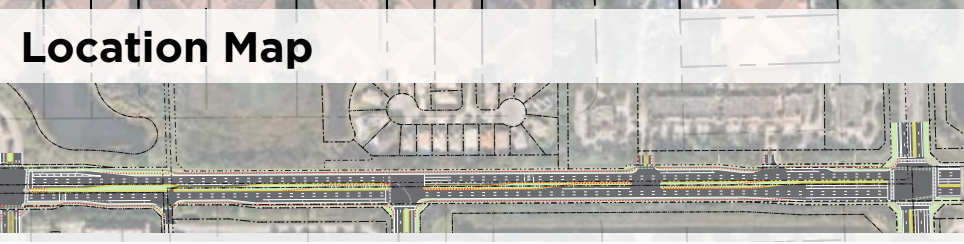
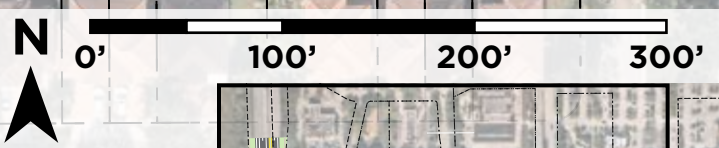

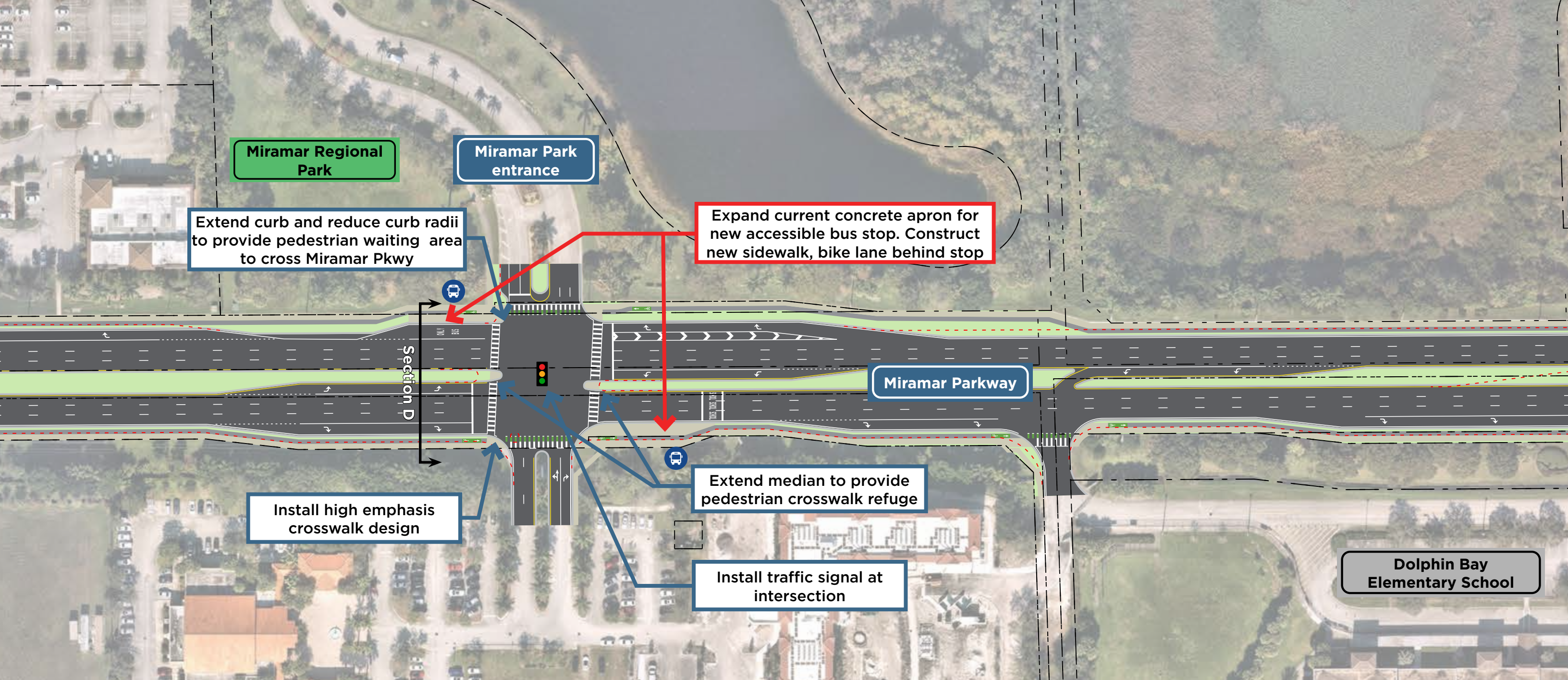
Note: These images and diagrams represent a planning concept based on cursory planning efforts. If concept advances, significant additional design would be required.

Please note: A warrant for the proposed traffic signal at the entrance to the Target Shopping Center would need to be obtained and approved by city staff with Broward County staff concurring with the findings.



-  : Bus Stop Location
-  : Location of Existing Trees
-  : Potential Removal of Trees
-  : Installation of Custom Inlet
-  : Installation of Traffic Signal

-  : Property/ROW line
-  : Location of existing pavement
-  : Road pavement
-  : Bike Lane
-  : Sidewalk
-  : Landscaping Area



Location Map

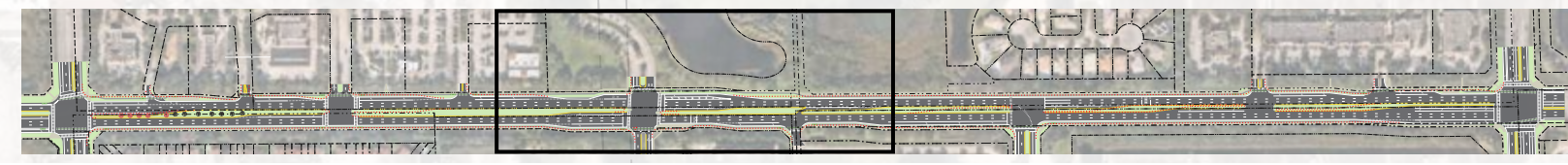

Note: These images and diagrams represent a planning concept based on cursory planning efforts. If concept advances, significant additional design would be required.

Please note: A warrant for the proposed traffic signal at this entrance to the Miramar Regional Park would need to be obtained and approved by city staff with Broward County staff concurring with the findings.

Alternate 1 Miramar Parkway west of the Miramar Park Entrance



Miramar Parkway

Reconstruct corner with reduce radius

Install high emphasis crosswalk design

Dolphin Bay Elementary School

SW 164th Avenue

Section E

- : Bus Stop Location
- : Location of Existing Trees
- : Potential Removal of Trees
- : Installation of Custom Inlet
- : Installation of Traffic Signal

- : Property/ROW line
- : Location of existing pavement
- : Road pavement
- : Bike Lane
- : Sidewalk
- : Landscaping Area



Location Map

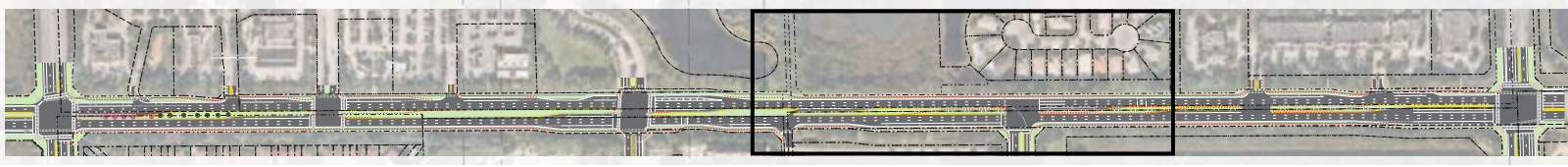

Note: These images and diagrams represent a planning concept based on cursory planning efforts. If concept advances, significant additional design would be required.

Alternate 1 Miramar Parkway Typical Section

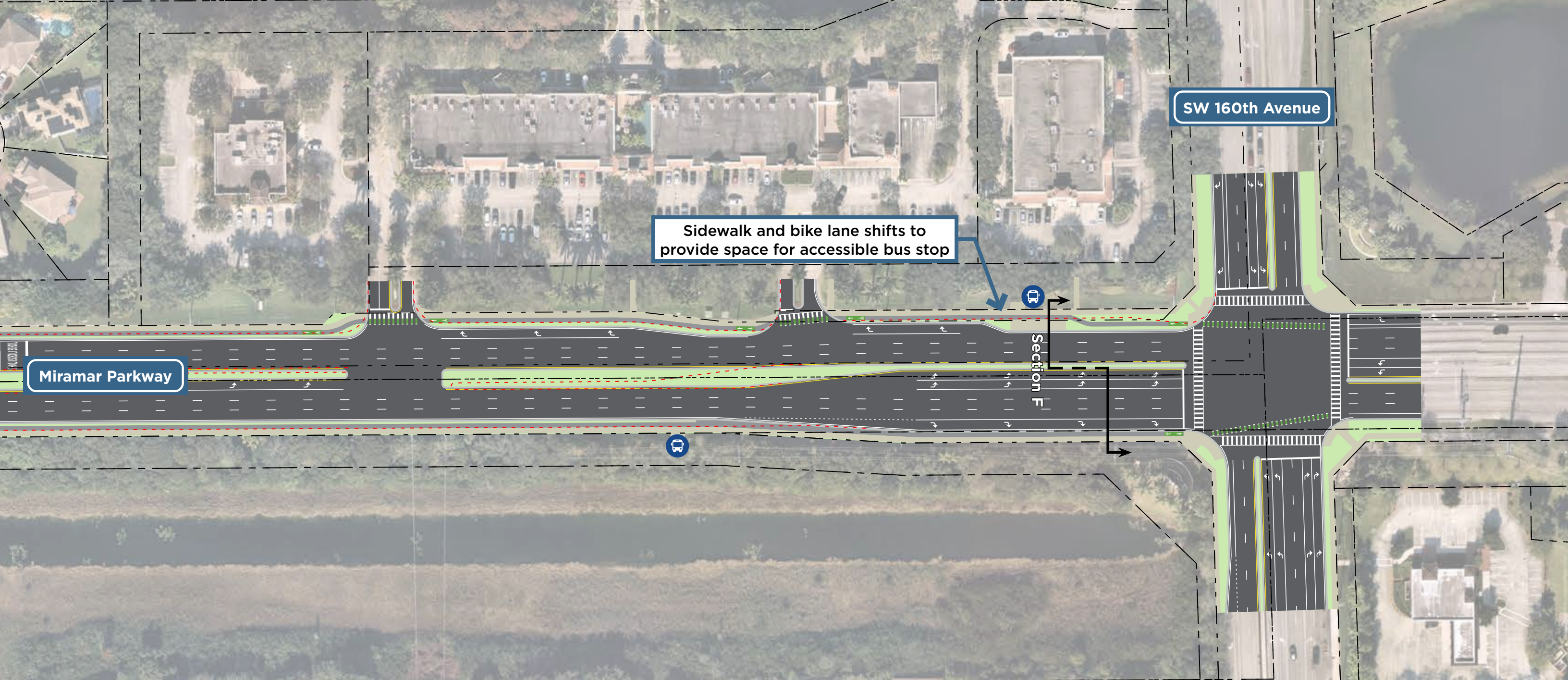

Miramar Parkway

SW 160th Avenue

Sidewalk and bike lane shifts to provide space for accessible bus stop

Section F

- : Bus Stop Location
- : Location of Existing Trees
- : Potential Removal of Trees
- : Installation of Custom Inlet
- : Installation of Traffic Signal

- : Property/ROW line
- : Location of existing pavement
- : Road pavement
- : Bike Lane
- : Sidewalk
- : Landscaping Area



Location Map



Note: These images and diagrams represent a planning concept based on cursory planning efforts. If concept advances, significant additional design would be required.